



Quick Start Guide &
Instruction Manual

This device complies with Part 15 of the FCC Rules. Operation is subject to the following two conditions:

- (1) this device may not cause harmful interference, and
- (2) this device must accept any interference received, including interference that may cause undesired operation.

Copyright© TrickleStar LLC 2016. All rights reserved.

TrickleStar® is a registered trademark of TrickleStar Ltd. All other trademarks are the property of their respective owners. The information in this document is subject to change without notice. TrickleStar assumes no responsibility for any errors that may appear in this document.

REV 14 / 8 Jan 2016

PRODUCT INFORMATION

TS1811

7 Outlet Advanced PowerStrip+,
1080 Joules, 4 ft. Cord, Auto Threshold,
Zigbee Multi-Sensor, TAV-Link



For technical support
go to www.tricklestar.com
or call 1-888-700-1098

www.tricklestar.com

Programming the Countdown Timer

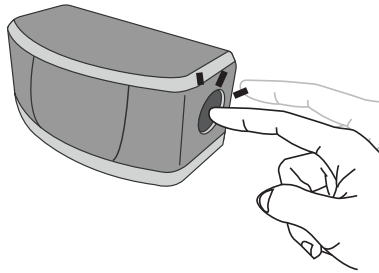

To configure the countdown timer, press and hold the button for 10 seconds until the red LED illuminates. Then press:

- Once for 30 minutes
- Twice for 60 minutes
- Three times for 120 minutes

LED will flash once for 30 minutes, twice for 60 minutes (default setting) and three times for 120 minutes.

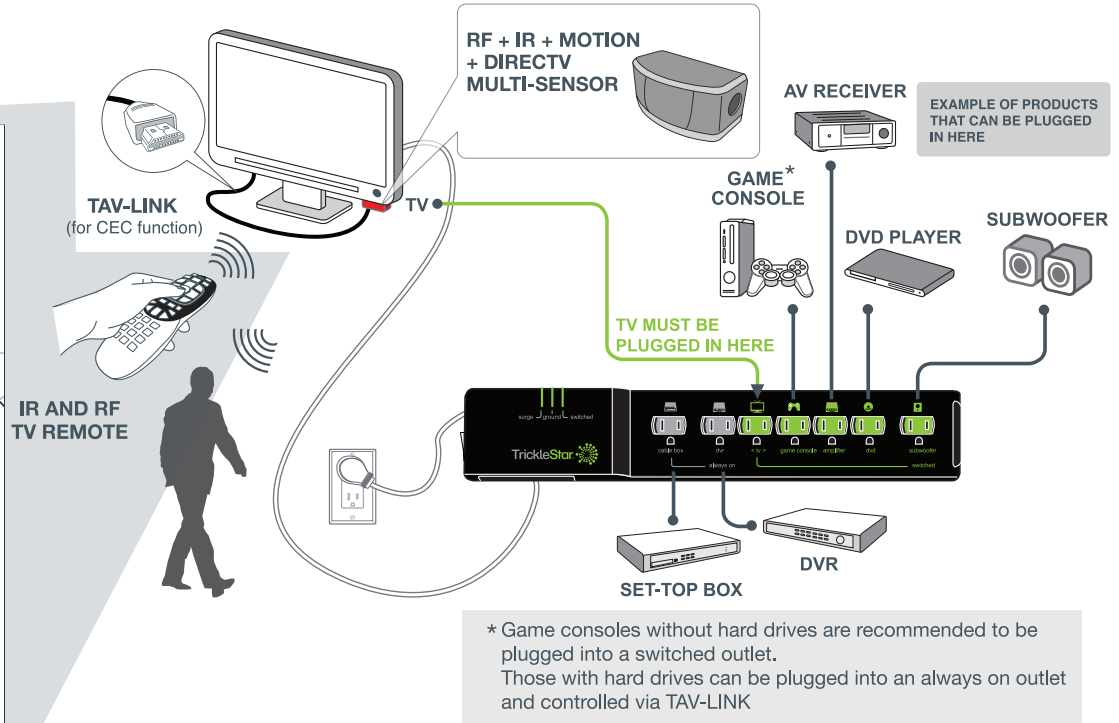

* Game consoles without hard drives are recommended to be plugged into a switched outlet. Those with hard drives can be plugged into an always on outlet and controlled via TAV-LINK

Installation

Step 1

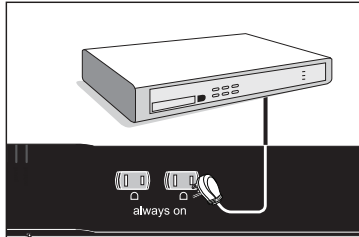

Plug in devices that require continuous power and devices with hard disk drives into the always on outlets.

TAV-Link: devices capable of receiving CEC commands via HDMI should still be plugged into the always on outlets and will be safely soft-switched off/placed into an energy saving mode. (see step 5)

Step 2

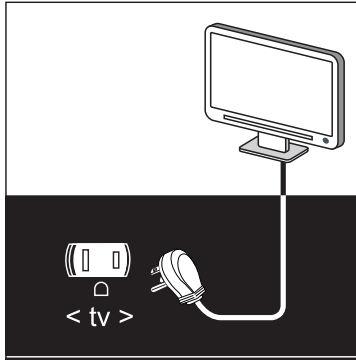

The TV must be plugged into the control outlet marked <tv>

Step 3

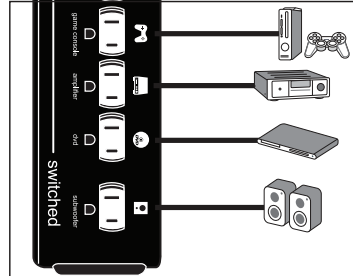

Plug the TV peripherals into the switched outlets.

note: all four switched outlets operate the same way. The icons serve only as examples of AV equipment that can be plugged into these outlets.

Step 4

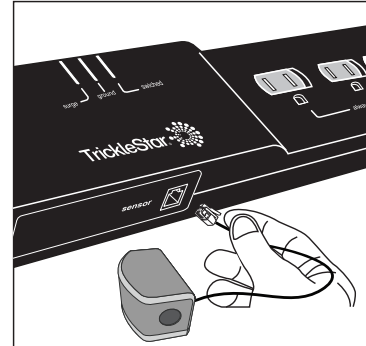

Plug the multi-sensor into the port on the side of the power strip that looks like a phone jack.

Step 5 - OPTIONAL

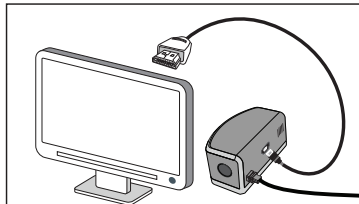

Plug the TAV-Link cable into the HDMI port on the TV if you have a smart TV or HDMI connected peripherals.

TAV-Link will soft-switch off (or place into an energy saving mode) HDMI connected peripherals capable of receiving CEC commands after no IR/RF remote control activity or motion is detected.

Step 6

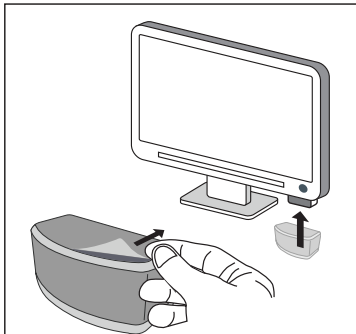

Remove the backing from the double sided tape on the back of the multi-sensor & affix to or near the TV.

Step 7

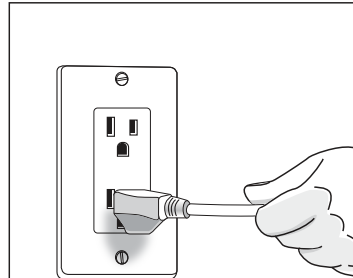

Plug the power strip into a grounded receptacle. The ground and surge lights will illuminate - indicating proper grounding and surge protection is functional.

Operation - TV Mode

Step 1

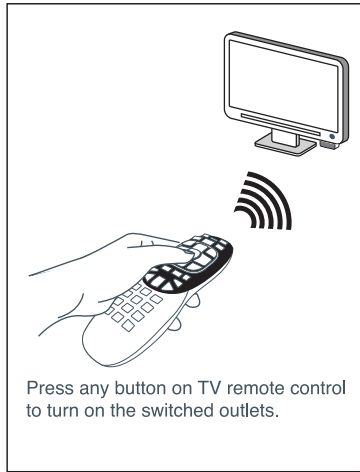

Step 2

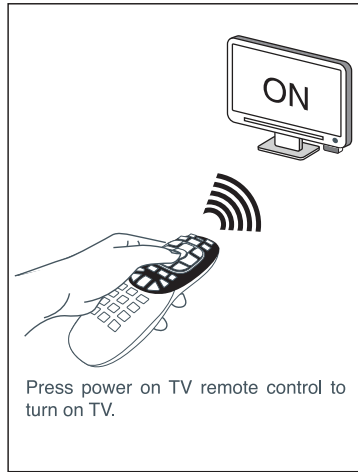

Step 3

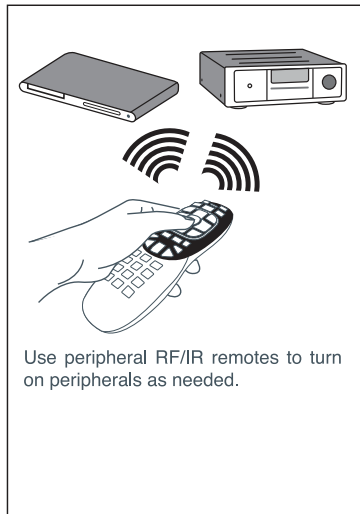

Step 4

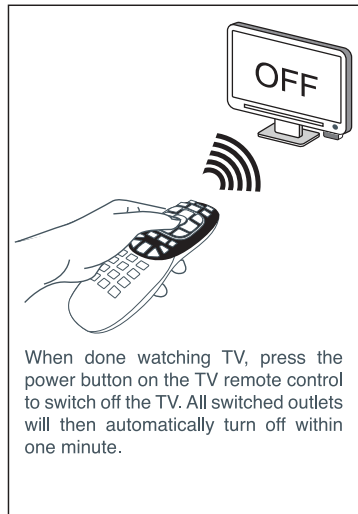

Energy Saving

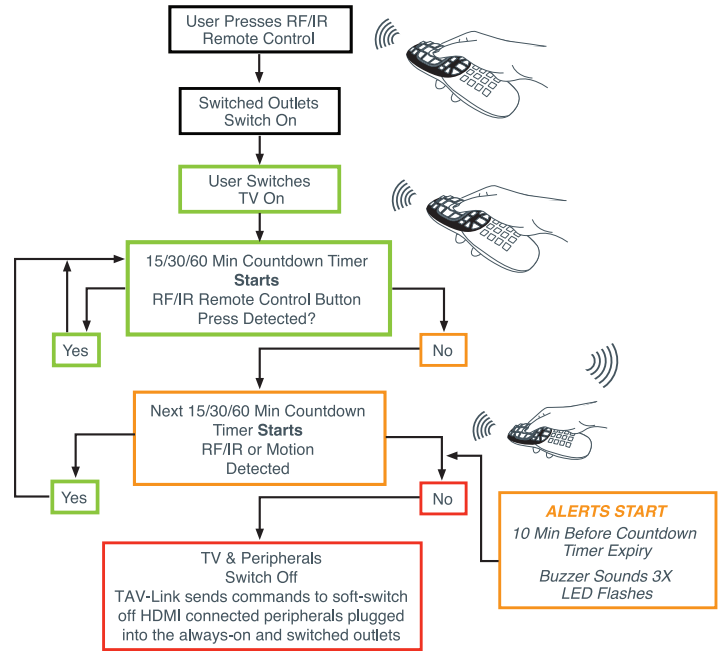

Terms

- IR** - Infrared signal, transmitted by a remote control
- IR Signal Sensor** - Multi-sensor senses for an IR command
- PIR Sensor** - Multi-sensor uses passive infrared sensing to detect movement
- RF** - Radio frequency, transmitted by a remote control
- Motion** - Motion detected by PIR
- Countdown Timer** - Time before the switched outlets are automatically switched off
- Countdown Period** - 30/60/120 minutes (default - 60 min.)
- LED** - Red LED located in multi-sensor
- When RF/IR or motion is sensed, the LED will flash
- Buzzer** - Buzzer located in the multi-sensor

Countdown Timer Operation

- For the first 15/30/60 minutes - the multi-sensor senses for RF/IR only.
- For the next 15/30/60 minutes - the multi-sensor senses for RF/IR signal or motion.
- If no RF/IR or motion has been sensed during the 30/60/120 minute countdown period, the switched outlets will switch off automatically.

Operation - Music Mode

Step 1



Press any button on AV receiver or set-up box/DVD/CD player remote control to turn on the switched outlets.

Press power on all music related devices to switch them on.

Note

- If the TV is not switched on at any time in between, all switched outlets will turn off after eight hours.
- If any RF/IR signal is detected, the countdown timer period will automatically reset for another eight hours.
- If the TV is switched on during music mode, the Advanced PowerStrip+ will switch to TV mode.

Operation - Countdown Timer Setting

Step 1

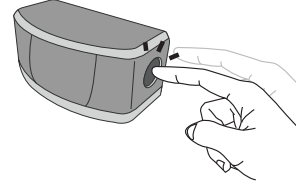

To configure the countdown timer, press and hold the button for 10 seconds until the red LED illuminates. Then press:

- Once for 30 minutes
- Twice for 60 minutes
- Three times for 120 minutes

After countdown timer is set, the LED will flash the number of times that timer has been set to.

Note

- The sensor has a default buzzer notification that will sound three times during the 10 minute countdown timer period.
- To disable the audible notification, press and hold the button for 10 seconds until the red LED illuminates, then press the button four times. The red LED will flash four times to confirm the countdown timer buzzer has been disabled.

Operation - RF Remote Control and Pairing

Step 1

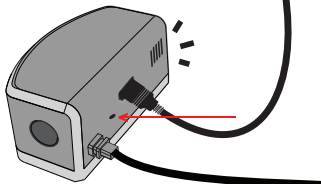

Quickly press the pinhole pairing button located on the back of the multi-sensor to trigger the pairing process.

A blue LED will flash for a period of 15 seconds - indicating the multi-sensor is in pairing mode.

Step 2

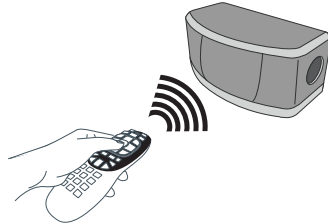

Place the RF remote control near the sensor (within two inches) and press the 0 key on the remote until the red LED on the sensor illuminates. Repeat with other RF remote controls (up to four).

Operation - Delete Paired RF Remote Control Address

Step 1

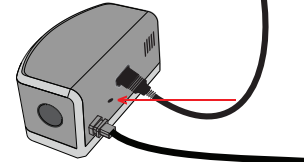

Press and hold the pinhole pairing button for five seconds.

Blue LED will illuminate for one second - indicating all paired remote control addresses have been erased.



1 RF/IR & Motion Multi-Sensor

The Zigbee multi-sensor is connected to the powerstrip via the RJ11 port marked "sensor." Mount the ZigBee multi-sensor on the underside of the TV, near the IR receiver on the TV (typically located next to the TV's power on/off button). The multi-sensor must be located within line of sight of where you normally use your remote controls.

2 Power Connection

The Product must only be plugged into a grounded receptacle for surge protection to operate correctly. All connected devices should be plugged directly into the Product. Use of an extension cord, adaptor or other powerstrip in conjunction with the Product will void all warranties.

3 Sensor/RJ11 Port

Plug the RF/IR & motion multi-sensor into this port. There will be a soft audible 'click' when the connector is inserted correctly.

4 Surge LED

When illuminated, it indicates that the surge protection is functioning normally. If this LED illuminates red or extinguishes at any time, the Product was sacrificed to protect your devices and must be replaced.

5 Ground LED

When illuminated, it indicates that the Product is correctly grounded. If not illuminated, there is a grounding problem and you must contact an electrician to properly ground the socket. Surge protection will not work with an improperly grounded outlet.

6 Switched Outlets LED

When illuminated, it indicates that the switched outlets are receiving power.

7 Resettable Circuit Breaker

All outlets on the Product are protected. If the surge, ground, and switched LEDs are not illuminated and/or connected devices are not receiving power, switch the circuit breaker to activate power.

8 Always-On Outlets

Equipment that requires continuous power should be plugged into the always-on outlets.

9 <tv> Outlet

The outlet marked <tv> is the control outlet and includes true RMS power measurement.

IMPORTANT

THE TV MUST BE PLUGGED INTO THIS OUTLET

10 Switched Outlets

If there is no RF, IR, or motion detected, these outlets will switch off.

11 TAV-Link Cable

If there is no RF, IR, or motion detected, TAV-Link will send high-level CEC commands to certain HDMI connected devices, allowing them to safely store their data and settings prior to powering down.

What can I plug into the APS+?

- Never insert any object other than a plug into the APS+ outlets.
- The APS+ is designed for use with indoor AV equipment. Do not use outdoors.
- Never use the APS+ for appliances other than AV equipment, such as a fridge, electric kettle, electric oven or microwave.
- Never use the APS+ for power tools such as power drills, bench saws and other power tools.

What AV equipment should I plug into the grey always on outlets?

- Plug in Audio Visual (AV) equipment that need constant power for recording features, timers and program guides such as:
 - TiVo
 - DVD recorders
 - Devices with a hard disk drive (HDD)
 - Digital receivers
 - Set-top boxes
 - Game console with a HDD

What AV equipment should I plug into the switched outlets?

- The TV must be plugged into the green outlet labelled < tv >. Plug in devices such as the following to the remaining switched outlets:
 - Blu-ray, DVD and CD player
 - Amplifiers
 - Game consoles without a HDD
 - Home theater speaker systems

How does the APS+ save energy?

- The APS+ saves energy through:

1) Master control

- All switched outlets are automatically switched off within one minute after the TV is switched off.

2) Energy saving features

- In TV mode all switched outlets are automatically switch off if there is no RF/IR remote control signal or motion detected during the countdown timer period.
- In music mode all switched outlets are automatically switched off after eight hours if there is no RF/IR remote control signal or motion is detected.
- By using the TAV-Link cable, HDMI connected peripherals capable of receiving CEC commands will automatically soft-switch off or enter a power saving mode if there is no RF/IR remote control signal or motion detected during the countdown timer period.

Problem	Solution
No power to outlets	The resettable switch must be at the reset position.
No power at switched outlets	The multi-sensor must be connected to the APS+ and RF or IR signal from any remote must be received to switch on the switched outlets. Alternatively, press the button on the multi-sensor to switch on switched outlets manually.
The TV peripherals do not switch off when the TV is off	Make sure that the TV is plugged into the outlet with the green TV icon. Make sure that the TV peripherals are connected to the green switched outlets (except for TV). The switched outlets will switch off after the TV has been switched off for one minute.
The multi-sensor is blinking on and off every 5 seconds	This is a notification that your TV will shut off in 10 minutes.
The TV keeps switching off after 30/60/120 minutes	The power saving/countdown timer shuts off the TV and peripherals after 30/60/120 minutes if no RF/IR signal or motion is sensed. To reset the time for another 30/60/120 minutes, press a button on an RF/IR remote control or move in front of the multi-sensor.

Product Warranty

The lifetime of the product (hereafter referred to as “Product Lifetime”), is 10 years.

TrickleStar warrants to the original purchaser that for the Product Lifetime, it shall be free of defects in design, assembly, material, or workmanship, and will repair or replace, at its option, any defective product free of charge.

CONNECTED DEVICE WARRANTY

TrickleStar will repair or replace, at its option, any devices which are damaged by a transient voltage surge/spike or lightning strike, (an “Occurrence”), while properly connected through the Product to a properly wired AC power line with protective grounding.

If applicable, the telephone line, and/or network line must be properly connected and installed, and the antenna cable line must also be properly connected and installed, as determined by TrickleStar at its sole discretion.

This Connected Device Warranty is a limited warranty, subject to the limitations and exclusions set forth herein. TrickleStar will repair or replace the damaged connected devices, at TrickleStar’s option, an amount equal to the fair market value of the damaged devices or the original purchase price of the devices, whichever is less, up to the maximum of \$20,000.

The fair market value of the devices shall be the current value of the devices specified in the most recent edition of the Orion Blue Book by Orion Research Corporation, Roger Rohrs Publisher.

TrickleStar reserves the right to review the damaged Product, the damaged devices, and the site where the damage occurred. All costs of shipping the Product and the damaged devices to TrickleStar for inspection shall be borne solely by the purchaser. TrickleStar reserves the right to negotiate the cost of repairs. If TrickleStar determines, in its sole discretion, that it is impractical to ship the damaged devices to TrickleStar, TrickleStar may designate, in its sole discretion, a repair facility to inspect and estimate the cost to repair such devices. The cost, if any, of shipping the devices to and from such repair facility and of such estimate shall be borne solely by the purchaser.

Damaged devices must remain available for inspection until the claim is finalized. Whenever claims are settled, TrickleStar reserves the right to be subrogated under any existing insurance policies the claimant may have. All above warranties are null and void if:

- The Product in use during the occurrence is not provided to TrickleStar for inspection upon TrickleStar’s request at the sole expense of the purchaser.
- TrickleStar determines that the Product has not been installed in accordance with the Installation Requirements, altered in any way or tampered with.
- TrickleStar determines that the damage did not result from the occurrence or that no occurrence in fact took place, the repair or replacement of the damaged devices is covered under a manufacturer’s warranty.
- TrickleStar determines that the connected devices were not used under normal operating conditions or in accordance with any labels or instructions.
- The Product is not plugged directly into a receptacle.
- The Product is “daisy-chained” together in serial fashion with other power boards, Uninterruptible Power Supplies, other surge protectors or extension cords.
- A three-to-two-prong adapter is used.
- The Product is not used indoors.

This Product is not for use with aquariums and all other water-related products. Use only indoors and in dry locations. The Connected Device Warranty only protects against damage to properly connected devices where TrickleStar has determined, in its sole discretion, that the damage resulted from an occurrence, and does not protect against acts of God (other than lightning) such as flood, earthquake, war, vandalism, theft, normal-use wear and tear, erosion, depletion, obsolescence, abuse, damage due to low voltage disturbances (i.e. brownouts or sags), non-authorized program, or system devices modification or alteration. This warranty contains the sole warranty of TrickleStar, there are no other warranties, expressed or, except as required by law, implied, including the implied warranty or condition of quality, merchantability or fitness for a particular purpose, and such implied warranties, if any, are limited in duration to the term of this warranty. Some states do not allow limitations on how long an implied warranty lasts, so the above limitations may not apply to you.

In no event shall TrickleStar be liable for incidental, special, direct, indirect, consequential or multiple damages such as, but not limited to, lost business or profits arising out of the sale or use of any Product, even if advised of the possibility of such damages. This warranty gives you specific legal rights, and you may also have other rights, which may vary from state to state. Some states do not allow the exclusion or limitation of incidental or consequential damage, so the above limitations may not apply to you.

This warranty is valid only for the original purchaser of the product. All damage claims against the product must be made within 15 days from the date of the occurrence and must be accompanied by a receipt for the damaged devices or the warranty is void.

Warranty is valid in USA and Canada.

MAKING A WARRANTY CLAIM

Go to: www.tricklestar.com and print our claim form and email it to warranty@tricklestar.com

Provide the following information:

- Product part number
- A list of the devices that were connected to the Product at the time of the occurrence
- A list of the devices that were damaged during the occurrence and the extent of the damage
- The date of the occurrence
- Where you purchased the Product
- When you purchased the Product
- A copy of original receipt

A customer service representative will then instruct you on how to forward your devices, receipt and Product in use during the “occurrence” and how to proceed with your claim.

COPYRIGHT & DISCLAIMER

© Copyright TrickleStar Ltd. All rights reserved. TrickleStar® is a registered trademark of TrickleStar. Any typographical, clerical or other error or omission in this document or other documents or information issued by TrickleStar shall be subject to correction without any liability on the part of TrickleStar without notice.